



MAXISTAB. STABILITY AT YOUR FEET

Maxistab: la gamma di stabilizzatori supplementari conosciuta in tutto il mondo per le sue caratteristiche tecniche e funzionali all'avanguardia e di alta affidabilità.

Maxistab: the range of supplementary outriggers known all over the world for its forefront and high reliable technical and functional features.

MAXISTAB
NH Next Hydraulics®

www.maxistab.com | www.nexthydraulics.com



NH Next Hydraulics®

NH Next Hydraulics®
RAISE YOUR EXPECTATIONS

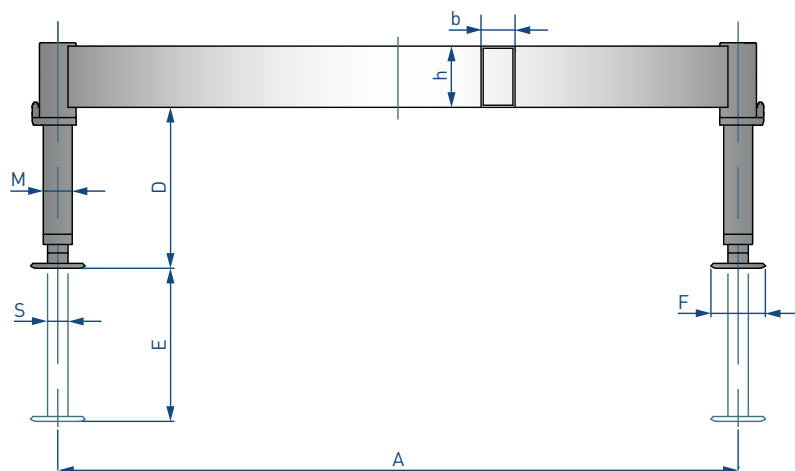

K - Regolazione in altezza
K - System for height adjustment

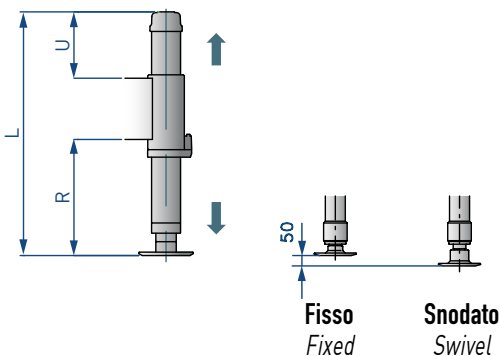

Gru Crane tm	daN MAX	Mod.	Dimensioni Dimensions (mm)										Peso Weight (kg)	Accessori Options				
			A	h x b	D (R max)	E	F	M	S	R min	U max	L		1	2	3	4	5
2-4	2.400	ML-F K	1.800	120 x 80	430	330	150	70	40	200	240	560	60	o	o	o	o	--
		ML-F / L K			500	400					310	630	62	o	o	o	o	--
4-10	3.000	0 F K	2.000	120 x 80	500	400	150	70	40	200	310	630	80	o	o	o	o	--
10-23	6.300	1 F K	2.000	180 x 100	510	450	160	85	60	240	300	720	125	o	o	o	o	--
		1 F / L K			610	550					400	820	130	o	o	o	o	--
18-35	8.250	2 F / S K	2.300	200 x 100	450	400	200	95	60	200	260	660	170	•	o	o	o	--
		2 F K			600	550					410	810	180	•	o	o	o	--
		2 F / L K			700	650					510	910	185	•	o	o	o	--

Cilindri girevoli manualmente Manual tilting stabilizer legs																
Gru Crane tm	daN MAX	Mod.	Dimensioni Dimensions (mm)							45° Standard Standard	Peso Weight (kg)	Accessori Options				
			A	h x b	D	E	F	M	S	90° A richiesta On request		1	2	3	4	5
2-4	2.400	ML-F GIR	1.800	120 x 80	480	330	150	70	40		60	o	o	o	--	
4-10	3.000	0 F GIR	2.000	120 x 80	480	330	150	70	40		75	o	o	o	--	
10-23	6.300	1 F GIR	2.000	180 x 100	590	450	160	85	60		125	o	o	o	--	
18-35	8.250	2 F / S GIR	2.300	200 x 100	530	400	200	95	60		170	•	o	o	--	
		2 F GIR			680	550				180	•	o	o	--		

o A richiesta On request • Standard Standard

Accessori Options				
1 - Valvole doppie 1 - Double acting valves 	2 - Piattello snodato 2 - Swivel foot 	3 - Comandi bilaterali 3 - Dual side controls 	4 - Prolunga stelo 4 - Rod extension ML - 0 = 100 mm 1 - 2 = 120 mm	5 - Arrotolatori 5 - Hose rollers

ESTENSIBILI CON ASTE OPPOSITE IN LINEA
Extendable with opposite lateral extensions

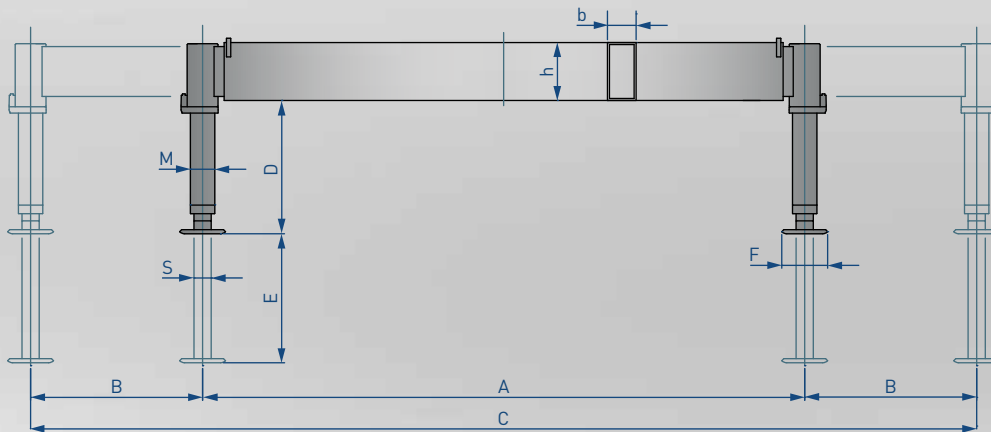

K - Regolazione in altezza
K - System for height adjustment

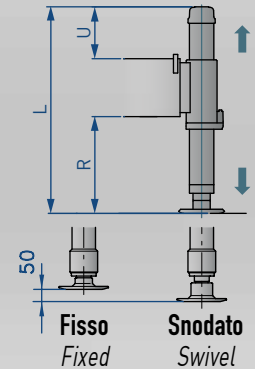

Gru Crane tm	daN MAX	Mod.	Dimensioni Dimensions (mm)												Peso Weight (kg)	Accessori Options				
			A	B	C	h x b	D (R max)	E	F	M	S	R min	U max	L		1	2	3	4	5
2-4	1.560	ML-E K	1.800	600+400	2.800	120 x 80	440	330	150	70	40	210	230	560	90	o	o	o	o	..
		510					400	300					630	92	o	o	o	o	..	
4-10	3.000	0 EMO K	2.100	600	3.300	150 x 100	490	400	150	70	40	190	290	630	125	o	o	o	o	..
10-25	6.300	1 EMO K	2.100	600	3.300	200 x 100	510	450	160	85	60	230	290	720	180	o	o	o	o	..
		1 EMO / L K					610	550					390	820	185	o	o	o	o	..
		1 EHO K					510	450					290	720	205	o	o	o	o	..
		1 EHO / L K					610	550					390	820	210	o	o	o	o	..
18-35	9.000	2 EMO / S K	2.100	600	3.300	200 x 120	460	400	200	95	60	210	250	660	225	•	o	o	o	..
		2 EMO K					610	550					400	810	235	•	o	o	o	..
		2 EMO / L K					710	650					500	910	240	•	o	o	o	..
		2 EHO / S K					460	400					250	660	245	•	o	o	o	..
		2 EHO K					610	550					400	810	255	•	o	o	o	..
		2 EHO / L K					710	650					500	910	260	•	o	o	o	..

Cilindri girevoli manualmente Manual tilting stabilizer legs

Gru Crane tm	daN MAX	Mod.	Dimensioni Dimensions (mm)								45° Standard Standard		Peso Weight (kg)	Accessori Options				
			A	B	C	h x b	D	E	F	M	S	90° A richiesta On request		1	2	3	4	5
2-4	1.560	ML-E GIR	1.840	600+400	2.840	120 x 80	480	330	150	70	40		85	o	o	o	o	..
4-10	3.000	0 EMO GIR	2.120	600	3.320	150 x 100	470	330	150	70	40		125	o	o	o	o	..
10-25	6.300	1 EMO GIR	2.120	600	3.320	200 x 100	590	450	160	85	60		180	o	o	o	o	..
		1 EHO GIR											200	o	o	o	o	..
18-35	9.000	2 EMO / S GIR	2.120	600	3.320	200 x 120	530	400	200	95	60		225	•	o	o	o	..
		2 EMO GIR					680	550					235	•	o	o	o	..
		2 EHO / S GIR					530	400				245	•	o	o	o	..	
		2 EHO GIR					680	550				255	•	o	o	o	..	

Estensione Extension M - Manuale M - Manual H - Idraulica H - Hydraulic A richiesta On request • Standard Standard

Accessori Options				
1 - Valvole doppie 1 - Double acting valves	2 - Piattello snodato 2 - Swivel foot	3 - Comandi bilaterali 3 - Dual side controls	4 - Prolunga stelo 4 - Rod extension	5 - Arrotolatori 5 - Hose rollers
			 ML - 0 = 100 mm 1 - 2 = 120 mm	

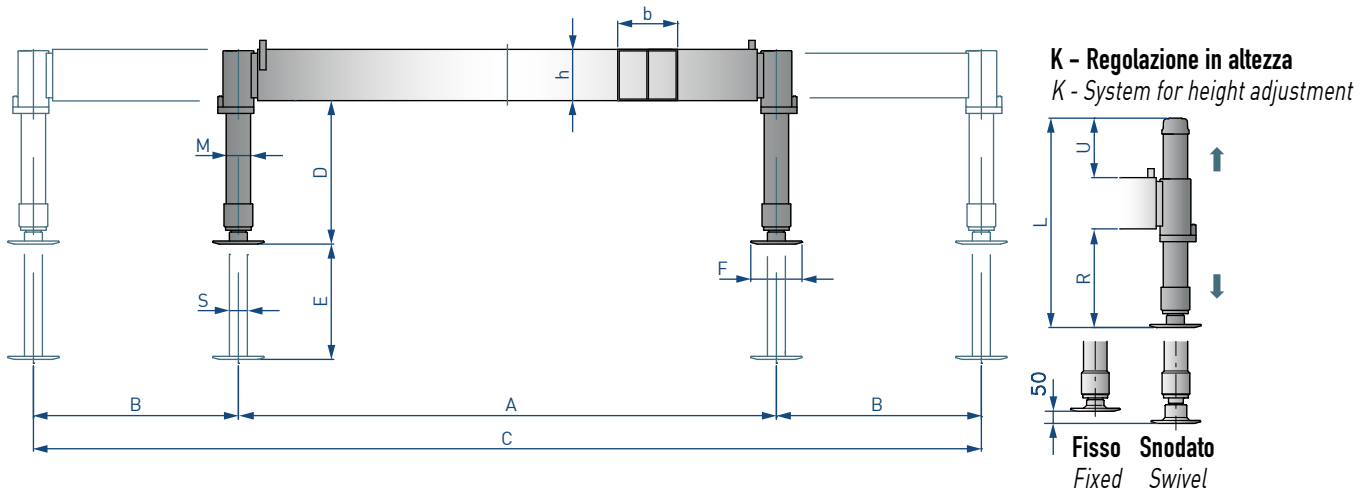

Gru Crane tm	daN MAX	Mod.	Dimensioni Dimensions (mm)											Peso Weight (kg)	Accessori Options					
			A	B	C	h x b	D (R max)	E	F	M	S	R min	U max		L	1	2	3	4	5
10-25	6.150	1 EMA K	2.100	1.150	4.400	200 x 200	510	450	160	85	60	230	290	720	240	○	○	○	○	..
		1 EMA / L K					610	550					390	820	245	○	○	○	○	..
		1 EHA K					510	450					290	720	275	○	○	○	○	..
		1 EHA / L K					610	550					390	820	280	○	○	○	○	..
18-35	9.000	2 EMA / S K	2.100	1.300	4.700	200 x 235	460	400	200	95	60	210	250	660	330	●	○	○	○	..
		2 EMA / K					610	550					400	810	340	●	○	○	○	..
		2 EMA / L K					710	650					500	910	345	●	○	○	○	..
		2 EHA / S K					460	400					250	660	370	●	○	○	○	..
		2 EHA K					610	550					400	810	380	●	○	○	○	..
		2 EHA / L K					710	650					500	910	385	●	○	○	○	..
30-45	10.500	3 EHA / S K	2.200	1.400	5.000	250 x 235	480	400	200	95	60	240	220	710	420	●	●	○	○	..
		3 EHA K					630	550					370	860	430	●	●	○	○	..
		3 EHA / L K					730	650					470	960	435	●	●	○	○	..

Cilindri girevoli manualmente Manual tilting stabilizer legs																					
Gru Crane tm	daN MAX	Mod.	Dimensioni Dimensions (mm)											45° Standard Standard		Peso Weight (kg)	Accessori Options				
			A	B	C	h x b	D	E	F	M	S	90° A richiesta On request	1	2	3		4	5			
10-25	6.150	1 EMA GIR	2.120	1.150	4.420	200 x 200	590	450	160	85	60	90° A richiesta On request	245	○	○	○	○	..			
		1 EHA GIR												290	○	○	○	○	..		
18-35	9.000	2 EMA / S GIR	2.120	1.300	4.720	200 x 235	530	400	200	95	60	90° A richiesta On request	320	●	○	○	○	..			
		2 EMA GIR					680	550						330	●	○	○	○	..		
		2 EHA / S GIR					530	400						360	●	○	○	○	..		
		2 EHA GIR					680	550						370	●	○	○	○	..		
30-45	10.500	3 EHA / S GIR	2.220	1.400	5.020	250 x 235	570	400	200	95	60	90° A richiesta On request	415	●	●	○	○	..			
		3 EHA GIR					720	550						425	●	●	○	○	..		

Estensione Extension M - Manuale M - Manual H - Idraulica H - Hydraulic A richiesta On request Standard Standard

Accessori Options				
1 - Valvole doppie 1 - Double acting valves	2 - Piattello snodato 2 - Swivel foot	3 - Comandi bilaterali 3 - Dual side controls	4 - Prolunga stelo 4 - Rod extension	5 - Arrotolatori 5 - Hose rollers
			120 mm	

ESTENSIBILI CON ASTE AFFIANCATE SERIE 4-5
Extendable with parallel lateral extensions series 4-5

Vers.: Standard / S / L

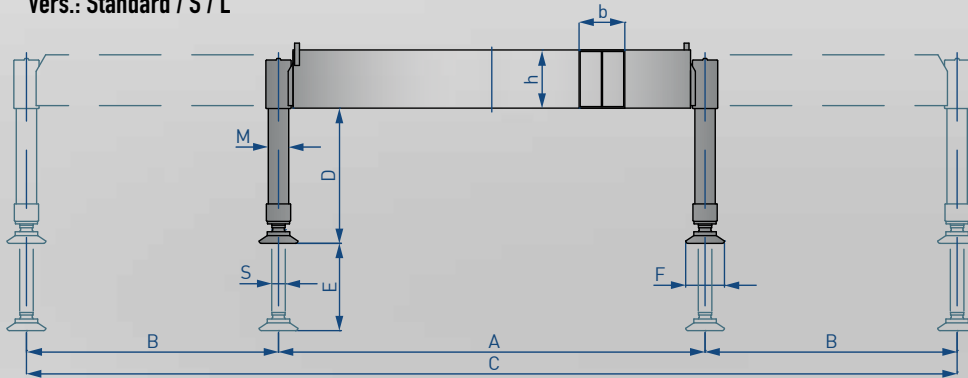

Vers.: / S-P

Vers.: / S-P AR

Vers.: / S-P CP AR

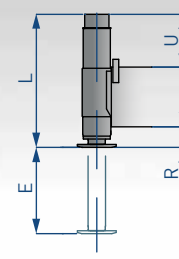
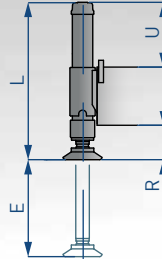
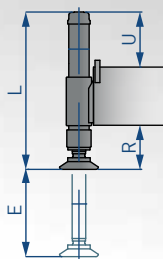

Gru Crane tm	daN MAX	Mod.	Dimensioni Dimensions [mm]												Peso Weight (kg)	Accessori Options							
			A	B	C	h x b	D	E	F	M	S	R	U	L		1	2	3	4	5			
40-60	14.000	4 EHA	2.200	1.400	5.000	300 x 235	700	200	105	70	230	285	810	490									
		4 EHA - P					--													650	265	395	960
		4 EHA / S					550													500	--	--	--
		4 EHA / S-P					--													500	230	285	810
		4 EHA / S-P AR					--													500	180	335	810
50-80	17.750	5 EHA / S	2.200	1.400	5.000	305 x 280	500	200	125	90	180	330	820	670									
		5 EHA / S-P					--												450	230	280	820	
		5 EHA / S-P AR					--												450	180	330	820	
		5 EHA / L					650												600	--	--	--	
		5 EHA S-P CP AR					106												450	200	125	90	106

Cilindri girevoli automatici Automatic tilting stabilizer legs

Gru Crane tm	daN MAX	Mod.	Dimensioni Dimensions [mm]							90° Standard Standard	Peso Weight (kg)	Accessori Options					
			A	B	C	h x b	F	M	S	45° A richiesta On request		1	2	3	4	5	
40-60	14.000	4 EHA GIR	2.240	1.400	5.040	300 x 235	200	105	70	70°	540						
		4 EHA / S GIR															
50-80	17.750	5 EHA / S GIR	2.240	1.400	5.040	305 x 280	200	125	90	90°	720						
		5 EHA / L GIR															740

Estensione Extension H - Idraulica H - Hydraulic

A richiesta On request • Standard Standard

Accessori Options

1 - Valvole doppie 1 - Double acting valves	2 - Piattello snodato 2 - Swivel foot	3 - Comandi bilaterali 3 - Dual side controls	4 - Prolunga stelo 4 - Rod extension	5 - Arrotolatori 5 - Hose rollers

Vers.: Standard / S / L

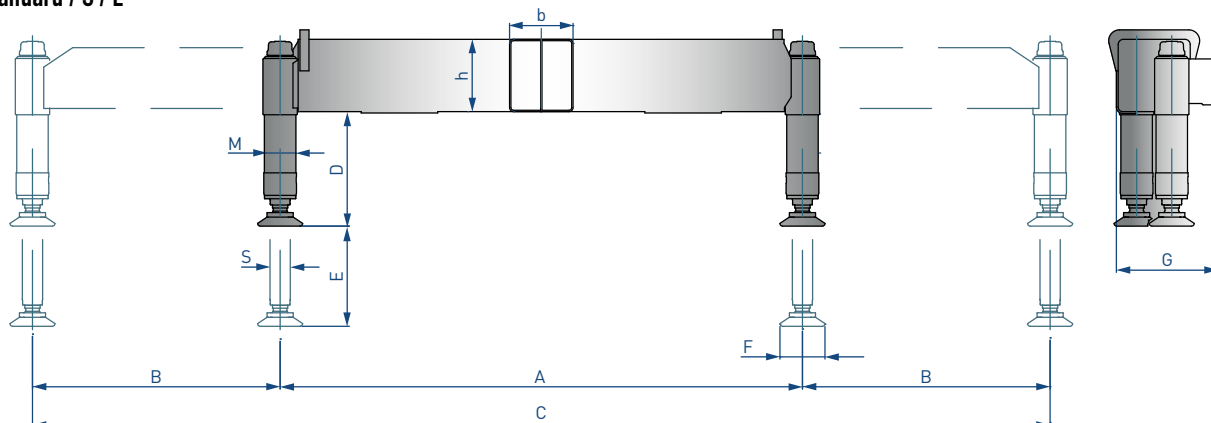

Vers.: / P / S-P

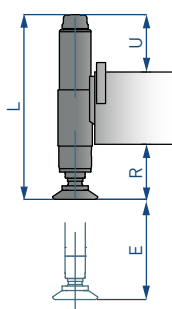

Vers.: / S-P AR

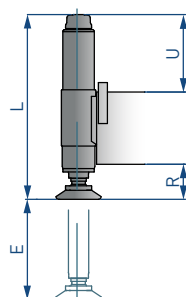

Vers.: / S-P CP AR

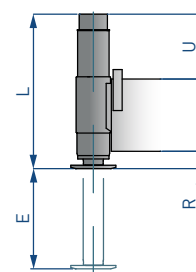

Gru Crane tm	daN MAX	Mod.	Dimensioni Dimensions (mm)												Peso Weight (kg)	Accessori Options													
			A	B	C	h x b	G	D	E	F	M	S	R	U		L	1	2	3	4	5								
40-60	12.500	4 ELHA	2.320	1.800	5.920	300 x 282	415	700	650	200	105	70	--	--	--	630	●	●	●	●	●								
		--						270					400	960	●		●	●	●	●									
		4 ELHA / P						2.350	1.800				5.950	320 x 320	452	550	450	200	125	90	--	--	--	610	●	●	●	●	●
		4 ELHA / S														--					230	290	810		●	●	●	●	●
		4 ELHA / S-P														--	180				340	810	●	●	●	●	●		
4 ELHA / S-P AR	5 ELHA / S	5 ELHA / S-P	5 ELHA / S-P AR	5 ELHA / L	5 ELHA / S-P CP AR	440	--	450	200	125	90	77	288	686	800	●	●	●	●	●									

Estensione Extension H - Idrraulica H - Hydraulic

○ A richiesta On request • Standard Standard

Accessori Options				
1 - Valvole doppie 1 - Double acting valves	2 - Piattello snodato 2 - Swivel foot	3 - Comandi bilaterali 3 - Dual side controls	4 - Prolunga stelo 4 - Rod extension	5 - Arrotolatori 5 - Hose rollers
			120 mm	

ESTENSIBILI CON ASTE AFFIANCATE A DOPPIA ESTENSIONE SERIE EX
Extendable with telescopic lateral extensions EX series



Vers.: / S / L

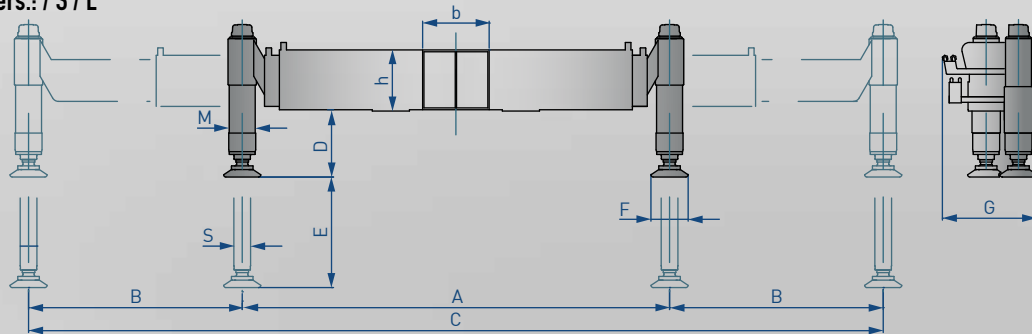

Vers.: / S-P

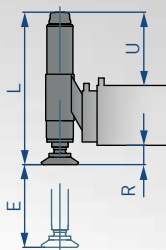

Vers.: / S-AR / L-AR

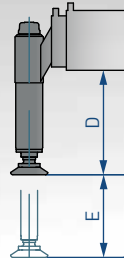

Vers.: / S-P CP

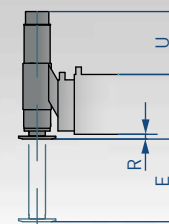

Gru Crane tm	daN MAX	Mod.	Dimensioni Dimensions (mm)											Peso Weight (kg)	Accessori Options						
			A	B	C	h x b	G	D	E	F	M	S	L		R	U	1	2	3	4	5
50-80	17.800	5 EXHA / S	2.300	2.300	6.900	320 x 350	522	360	450	200	125	90	--	--	--	900	●	●	--	--	○
		5 EXHA / S-P						--	450				820	110	390		●	●	--	--	○
		5 EXHA / S-AR						560	450				--	--	--		●	●	--	--	○
		5 EXHA / L-AR						710	600				--	--	--		●	●	--	--	○
		5 EXHA / S-P CP						--	--				--	--	--		●	○	--	--	○
70-100	21.500	6 EXHA / S	2.300	2.300	6.900	330 x 445	614	360	450	200	125	90	--	--	--	1.200	●	●	--	--	○
		6 EXHA / S-P						--	450				820	100	390		●	●	--	--	○
		6 EXHA / S-AR						560	450				--	--	--		●	●	--	--	○
		6 EXHA / L-AR						710	600				--	--	--		●	●	--	--	○

Cilindri girevoli automatici Automatic tilting stabilizer legs

Gru Crane tm	daN MAX	Mod.	Dimensioni Dimensions (mm)							90° Standard Standard		Peso Weight (kg)	Accessori Options				
			A	B	C	h x b	G	F	M	S	45° A richiesta On request		1	2	3	4	5
50-80	17.800	5 EXHA / S-GIR	2.300	2.300	6.900	320 x 350	522	200	125	90		900	●	●	--	--	○
		5 EXHA / L-GIR										960	●	●	--	--	○
70-100	21.500	6 EXHA / S-GIR	2.300	2.300	6.900	330 x 445	522	200	125	90		1.250	●	●	--	--	○
		6 EXHA / L-GIR										1.260	●	●	--	--	○

Estensione Extension H - Idrraulica H - Hydraulic

○ A richiesta On request • Standard Standard

Accessori Options

1 - Valvole doppie 1 - Double acting valves	2 - Piattello snodato 2 - Swivel foot	3 - Comandi bilaterali 3 - Dual side controls	4 - Prolunga stelo 4 - Rod extension	5 - Arrotolatori 5 - Hose rollers

Vers.: / S / L

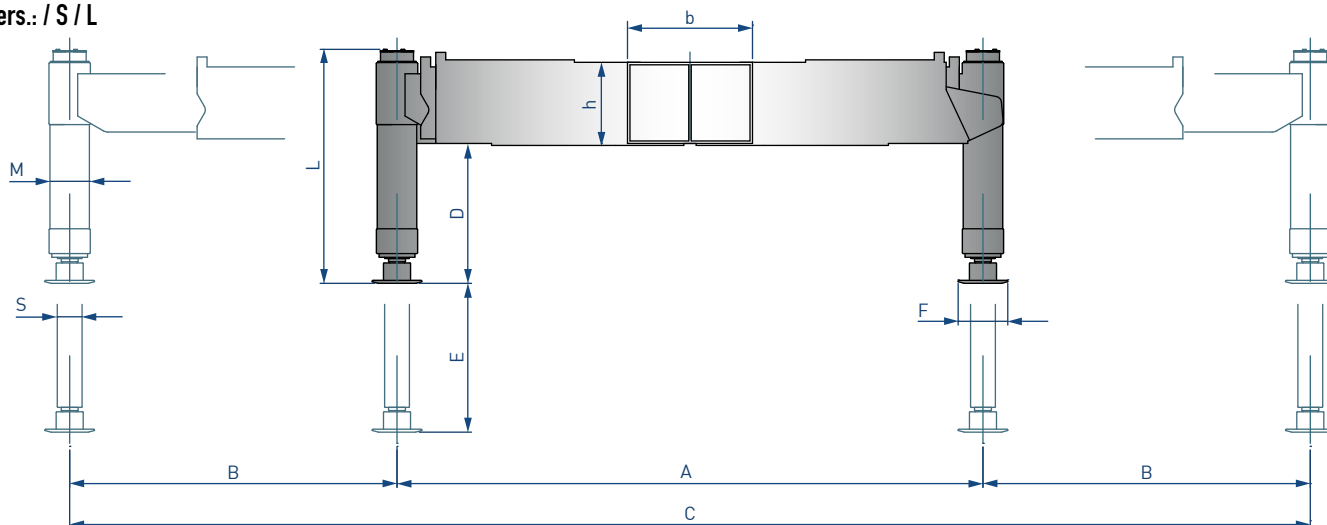

Vers.: / S / P

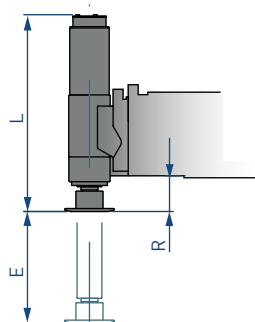

Gru Crane tm	daN MAX	Mod.	Dimensioni Dimensions (mm)													Peso Weight (kg)	Accessori Options				
			A	B	C	h x b	D	E	F	M	S	L	R	U	1		2	3	4	5	
50-80	15.000	5 EXPHA / S	2.300	2.800	7.900	320 x 350	370	450	200	125	90	--	--	--	1.000	•	•	--	--	•	
		5 EXPHA / S-P					--	450				820	110	390		•	•	--	--	•	
		5 EXPHA / L					520	600				--	--	--		1.010	•	•	--	--	•
70-100	19.000	6 EXPHA / S	2.300	2.800	7.900	330 x 445	360	450	200	125	90	--	--	--	1.350	•	•	--	--	•	
		6 EXPHA / S-P					360	450				820	100	390		•	•	--	--	•	
		6 EXPHA / L					510	600				--	--	--		1.360	•	•	--	--	•
90-140	25.000	7 EXPHA / S	2.350	3.000	8.350	330 x 505	410	450	200	140	100	--	--	--	1.570	•	•	--	--	•	
		7 EXPHA / S-P					--	450				795	145	320		•	•	--	--	•	
	7 EXPHA / L	560					600	--				--	--	1.590	•	•	--	--	•		
	28.000	8 EXPHA / S-P	2.350	3.000	8.350	385 x 505	--	450	200	140	100	795	120	290	1.740	•	•	--	--	•	

Estensione Extension H - Idraulica H - Hydraulic

◦ A richiesta On request • Standard Standard

Accessori Options				
1 - Valvole doppie 1 - Double acting valves	2 - Piattello snodato 2 - Swivel foot	3 - Comandi bilaterali 3 - Dual side controls	4 - Prolunga stelo 4 - Rod extension	5 - Arrotolatori 5 - Hose rollers

STABILIZZATORI A SEZIONE RIBASSATA

Low profile stabilizers

MAXISTAB
Next Hydraulics

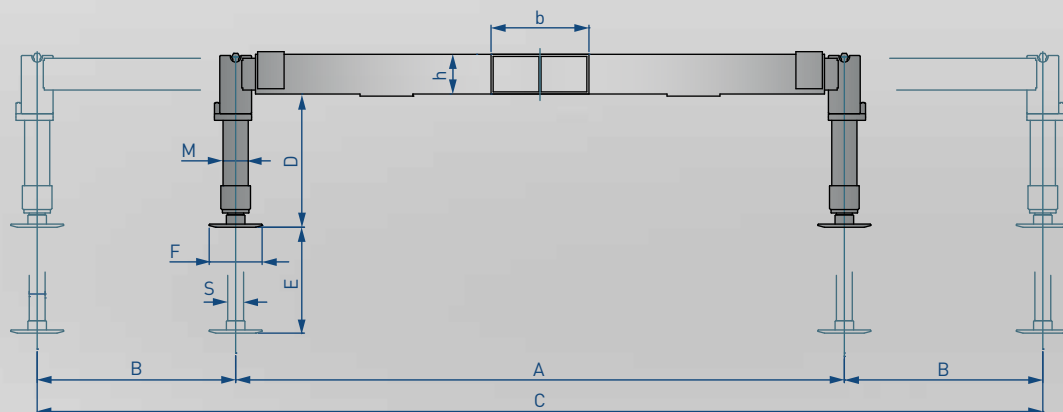

Gru Crane	daN MAX	Mod.	Dimensioni Dimensions (mm)										Peso Weight (kg)	Accessori Options				
			A	B	C	h x b	D (R max)	E	F	M	S	L		1	2	3	4	5
18-35	7.200	2 ECHA K	2.300	1.300	4.900	150 x 370	655	550	200	95	60	800	510	●	○	--	○	○
		2 ECHA / S K					505	400				650		500	●	○	--	○
40-60	8.400	4 ECLHA	2.350	1.300	4.950	150 x 420	791	650	200	105	70	936	630	●	●	--	○	○
		4 ECLHA / S					641	500				786		620	●	○	--	○

Estensione Extension H - Idrraulica H - Hydraulic

○ A richiesta On request • Standard Standard

Accessori Accessories				
1-Valvole doppie 1-Double acting valves	2-Piattello snodato 2-Swivel foot	3-Comandi bilaterali 3-Dual side controls	4-Prolunga stelo 4-Rod extension	5-Arrotolatori 5-Hose rollers
			120 mm	

CILINDRI PER MONTAGGIO ANTERIORE

Cylinders for front chassis mounting

MAXISTAB
Next Hydraulics

Cilindri per montaggio anteriore su veicoli

Gamma di cilindri per montaggio anteriore. Tutti i kit sono comprensivi di valvole di blocco doppie e manicotti sede cilindro da saldare. NB: Flangia non inclusa

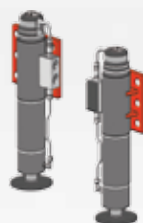

Cylinders for front truck mounting

Range of cylinders for front mounting. All kits include double acting valves and cylinder sleeves to weld. NB: Mounting Flange not included

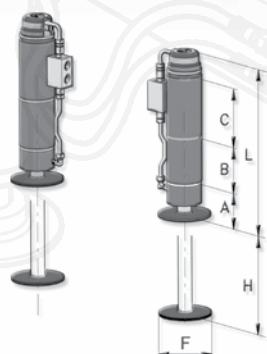

Descrizione Description	daN MAX	Dimensioni Dimensions (mm)					
		A	B	C (altezza manicotto) (cyl. sleeve height)	Ø F	H	L
Coppia di cilindri corti GR 4 con piattelli fissi Short cylinder couple GR4 with stiff foot plates	19.000	177	0	250	200	500	763
Coppia di cilindri corti GR 5 con piattelli fissi Short cylinder couple GR5 with stiff foot plates	25.600	188	258	250	200	450	772
Coppia di cilindri lunghi GR 5 con piattelli fissi Long cylinder couple GR5 with stiff foot plates	25.600	188	408	250	200	600	922

microswitch controllo aste estese e rientrate.

- Segnalazioni piedi in appoggio tramite pressostati, micro o sensori di prossimità.

Range of compliance kits to the European standards concerning stability control and safety.

- *Kit microswitches for extended and retracted rods control.*
- *Legs leaning on the ground signaling through switches, micro or proximity sensors.*

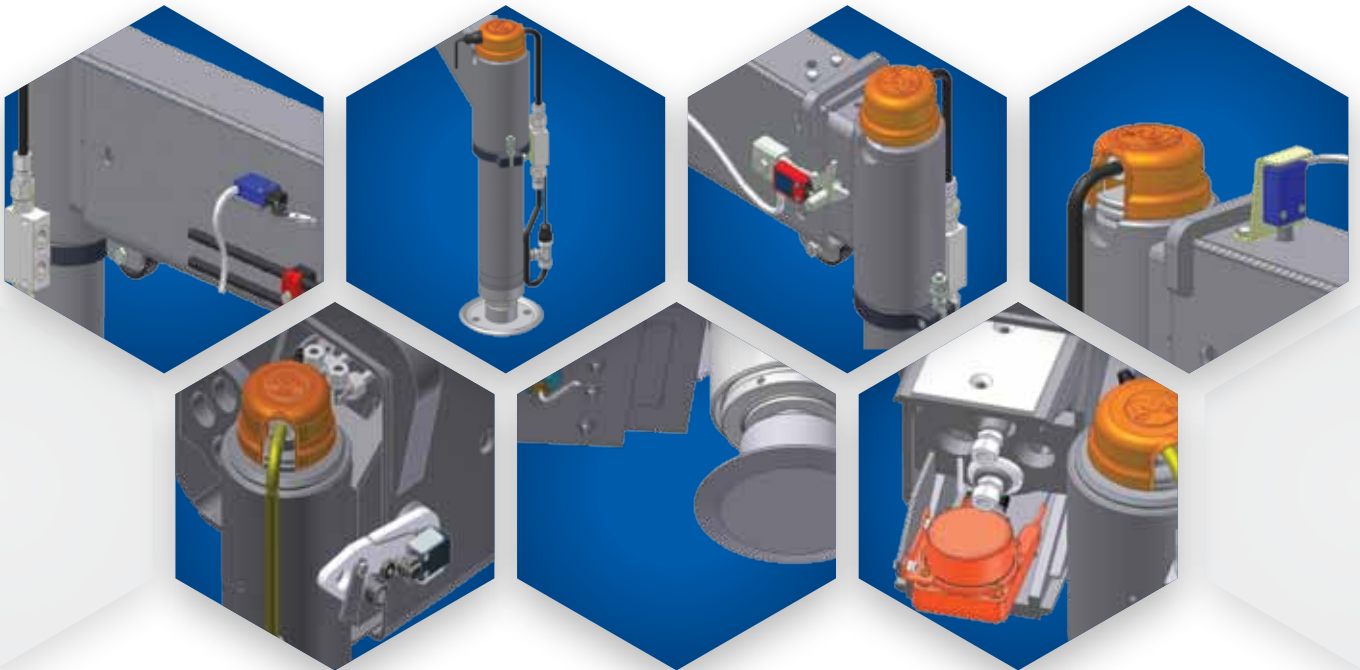



Maxistab è la scelta logica per chi vuole realizzare un allestimento ineccepibile. La molteplicità di versioni e accessori, ineguagliata sul mercato mondiale, permette la soddisfazione di ogni esigenza di allestimento di veicoli da trasporto, sollevamento e manutenzione, con soddisfazione dell'allestitore e dell'utilizzatore e nel rispetto di norme di sicurezza sempre più restrittive.

Maxistab is the logical choice for those who want to achieve an unexceptionable equipment. The variety of versions and accessories, unmatched in the world market, allows the satisfaction of any equipment needs of transport, lifting and maintenance vehicles, with user and bodybuilder satisfaction and in compliance with more and more restrictive safety regulations.



MAXISTAB. STABILITY AT YOUR FEET

I vantaggi e caratteristiche:

- Conformità alla **Direttiva 2006/42/EC**.
- Compattezza e leggerezza, grazie all'utilizzo degli **acciai altore-sistenziali più avanzati**.
- Stabilizzatori **forniti completamente montati**.
- Componentistica **oleodinamica ed elettrica della migliore qualità**.
- Verniciatura **in poli-acrilico colore nero, sovraverniciabile**.
- **Imballo con sostegno in legno** per agevole movimentazione con carrello elevatore o trans pallet.
- **Disponibilità ed intercambiabilità dei ricambi** fin dalle prime serie prodotte.
- Ogni stabilizzatore è corredato di **Dichiarazione di Conformità "CE"** e **set di adesivi da applicare al montaggio**, dopo verniciatura.
- **Le direttive di montaggio e i manuali ricambi** vengono forniti con gli stabilizzatori e sono sempre disponibili on-line previo accesso autorizzato ad area riservata su sito **www.nexthydraulics.com**

Advantages and characteristics:

- *Compliance with **2006/42/EC Directive**.*
- *Compact dimensions and lightness due to use of the **most advanced high strength steels**.*
- *Stabilizers **fully assembled provided**.*
- *Hydraulic and electrical components of the **highest quality**.*
- *Black colour, poly-acrylic coating, can be overpainted.*
- *Packing on wood base suitable for handling by forklift or transpallet.*
- *Availability and interchangeability of spare parts since the first series.*
- *Each stabilizer is fitted with relevant "**CE**" Declaration and decal kit to be applied after mounting and repainting.*
- *Installation Instructions and full Spare Parts Manual coming with the stabilizers and available on-line against authorized access to reserved area on **www.nexthydraulics.com** website.*